



Australian & New Zealand **ADDICTION CONFERENCE**

Monday 9th – Wednesday 11th May 2022

JW Marriott Gold Coast Resort and Spa

Hosted by



**Australian & New Zealand
Mental Health Association**



**Queensland
Mental Health
Commission**



**Victorian
Responsible
Gambling
Foundation**

#ADD22 | anzmh.asn.au/addiction-conference

Floor Plan

Plenary Sessions	Ballroom 1
Breakout Sessions	Ballroom 1, Ballroom 2 and Tamborine Gallery
Speakers Prep	Beechmont 2
Exhibition	Ballroom and Tamborine Foyers
Catering	Ballroom and Tamborine Foyers
Workshops	Springbrook and Binna Burra

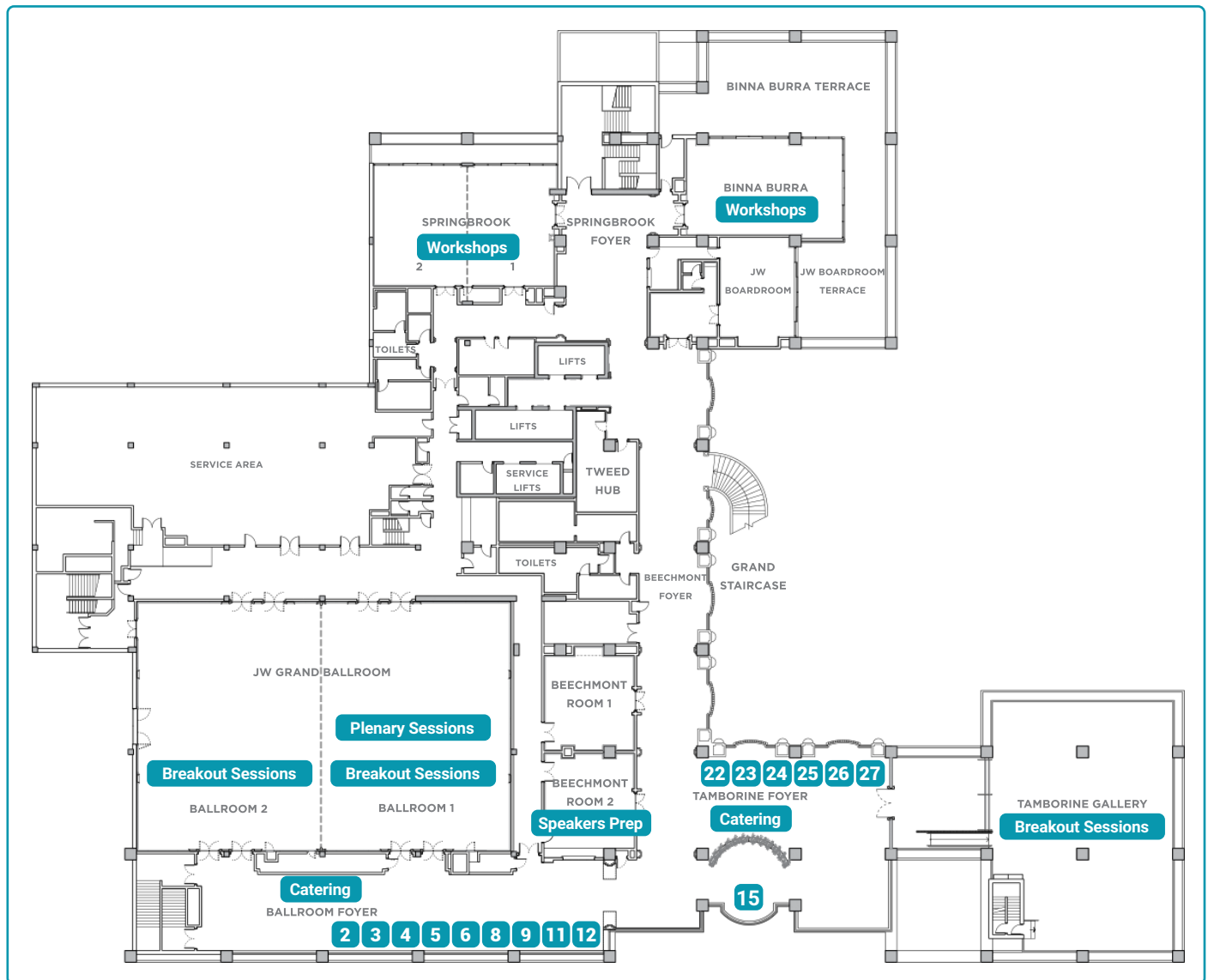

Exhibitor Listing

2 Aurora Healthcare	9 Indivior	23 Cracks in the Ice
3 Camurus Pty Ltd	11 eMHPPrac	24 Lives Lived Well
4 South Pacific Private	12 PDP Seminars	25 Australian Indigenous HealthInfoNet
5 AbbVie	15 Australian & New Zealand Mental Health Association	26 Dardi Munwurro
6 AbbVie	22 The Banyans Healthcare Group	27 The Buttery
8 Victorian Responsible Gambling Foundation		

Welcome

On behalf of the Program Advisory Committee and the Australian & New Zealand Mental Health Association, I would like to welcome you to the 2022 Australian & New Zealand Addiction Conference.

Building on the success of previous conferences, the theme for our 8th conference in 2022 is **'Bold Dreams & New Directions'**. I look forward to delving deeper, exploring, and learning real-world insights across our conference topics of prevention, treatment, and recovery.

Whether you work in community health, allied health, primary care or mental health, you play an important role in the client journey to recovery. We believe in the power of community, healing and connection to create greater change. Individual risk factors add a layer of complexity to substance use and dependence, gambling and other and compulsive behaviours; however, with innovative strategies in prevention, intervention and treatment, we will see a shift.

During the conference you'll have the opportunity to participate in a variety of presentations including keynotes, individual papers, panels, posters, and workshops. We will also extend a warm welcome to virtual delegates from all around Australia and New Zealand who will join us at these sessions. In addition, you will be able to view all presentation recordings (excluding workshops) from our resource centre for up to 30 days after the conclusion of the conference.

Don't forget to make time to visit our sponsors and exhibitors who are eager to meet to discuss their range of products and services available to you. Our exhibition will be open during the first two days of the conference in the Ballroom and Tamborine Foyers.

On a final note, I would like to thank each of you for attending and encourage you to connect, participate and engage with your fellow colleagues to equip yourself with the knowledge you need to be part of the solution. Remember to ask yourself, *if you can make one change, what would it be?*



Sam Stewart, CEO, Australian & New Zealand Mental Health Association

Acknowledgement

We would like to acknowledge the valuable contribution of all **committee members** and **session chairs** for their time and expertise with the conference program.

Program Committee

Dr Yvonne Bonomo, Director, Department of Addiction Medicine, St Vincent's Hospital, Melbourne

Carol Daws, Chief Executive Officer, Cyrenian House

Dr Michael Doyle, Senior Research Fellow, The University of Sydney

Dr Stefan Gruenert, Chief Executive Officer, Odyssey House Victoria

Lieutenant Colonel Lynette Hutson, National Director, The Salvation Army, New Zealand Fiji, Tonga & Samoa Territory

Dr Eli Kotler, Medical Director, Malvern Private Hospital

Dr Christian Rowan, Chief Medical Officer, The Banyans Healthcare Group

Todd Sellwood, AOD Nurse Navigator, Princess Alexandra Hospital

Bridgitte Thornley, National Director, PGF Group

Dr Hester Wilson, Addiction Medicine Specialist

General Information

The following information is provided to make your attendance at the 2022 Australian & New Zealand Addiction Conference as pleasant as possible. If you require help, please visit the conference team at the registration desk.

Registration and Information Desk

The registration desk is located on level two of the JW Marriott Gold Coast Resort & Spa, accessible by the stairs or lift. The hours of operation are as follows:

Monday 9 May 7:45am – 5:00pm
Tuesday 10 May 8:30am – 4:30pm
Wednesday 11 May 8:30am – 12:30pm

Name Badge

Please collect your name badge from the registration desk and wear it each day as it is your official pass to all sessions, exhibition, morning tea, lunch, afternoon tea and the social function.

Wi-Fi

Complimentary Wi-Fi internet is available in all event areas. Please use the network: Marriott. A password is not required.

Mobile Phones

Please ensure all mobile phones are switched to silent while in conference sessions.

On-Site Counsellor

During the conference, if you feel the need to speak to someone, please visit the registration desk. We are here to support you.

Conference Catering

All catering will be served in the Ballroom and Tamborine Foyer.

Networking Function

The networking function will be held on Monday 9 May from 5:00pm – 6:00pm in the Tamborine Foyer and Gallery. Drinks and canapes will be served.

Accommodation

Accommodation accounts must be settled with the hotel on checkout. The Committee and/or Conference Secretariat are not responsible in any way for outstanding accommodation accounts.

Resource Centre

As part of your conference registration, you receive access to the 2022 Australian & New Zealand Addiction Conference presentation recordings. This online library includes presentation slides and video recordings that can be watched on demand for 30 days. Your login details will be sent to you via email approximately five business days after the conference.

Key Contacts



Conference Manager

Justine White

T 07 5502 2068

E addictionconference@anzmh.asn.au

Program & Research Manager

Rachel Dempster

T 0431 917 300

E research@anzmh.asn.au

Business Partnerships Manager

Talitha Natt

T 0451 602 265

E partner@anzmh.asn.au

COVID Safe

Please stay home if you are feeling unwell or showing symptoms of COVID-19 - fatigue, shortness of breath or fever. Whilst masks are no longer mandatory, you are welcome to bring and wear your own.

Conference App

Want To Make The Most Of Your Conference Experience?

Download the conference app! Simply follow these easy steps:

1. Visit the app store on your Apple or Android device
2. Search 'The Event App by EventsAir' and download
3. Open and enter event code **ADD22**
4. Your name badge has your login and pin!

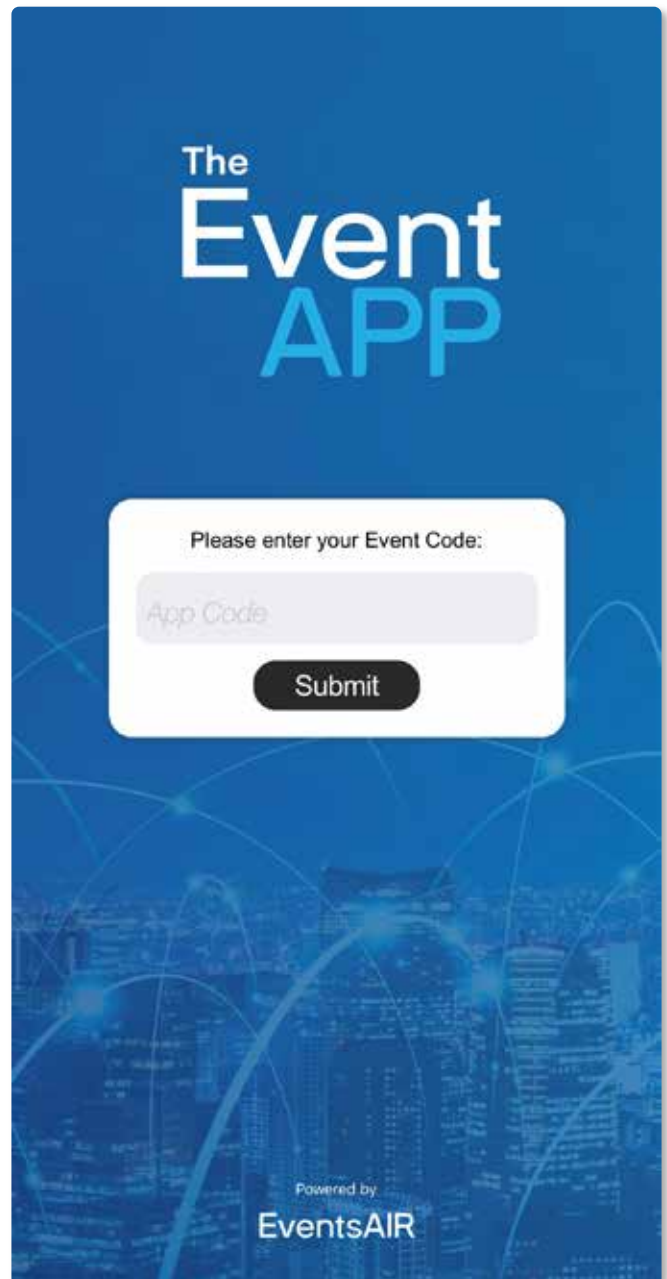
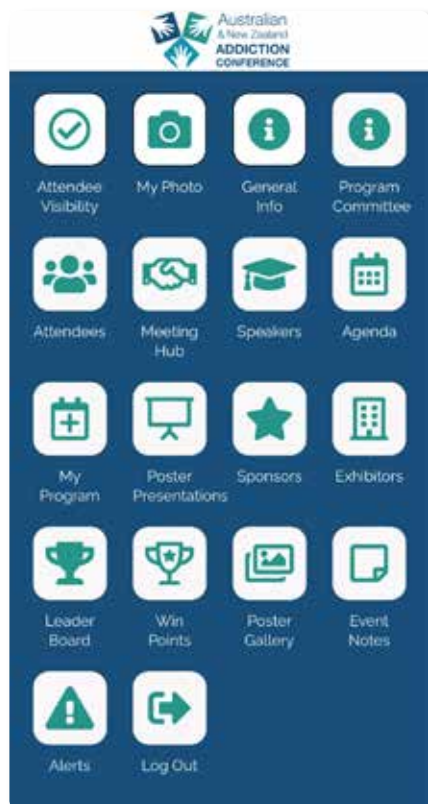

App Features

Stay up to date and connected during the Australian & New Zealand Addiction Conference.

PROGRAM Create your own personal schedule and view the latest program details.

SPEAKERS Read speaker biographies and presentation overviews.

NETWORK Connect with fellow delegates and network via in-app messaging.

CONNECT View who has joined us as an exhibitor and sponsor.

SHARE Engage with the session through social media.

GAMIFICATION Compete for prizes - it's fun and easy.



Do your clients have an issue with gambling?

When people experience gambling problems, they may also experience a range of co-occurring conditions, including mental ill-health, substance use disorders, and family issues.¹

Health and community services professionals are encouraged to contact Gambler's Help directly to discuss client needs and get assistance with referrals.

Our specialist counsellors can help you support your client, and change the way they think about gambling.

Call **1800 858 858** for your local Gambler's Help service or visit **gamblershelp.com.au**



Gambler's Help
1800 858 858



Victorian Responsible Gambling Foundation

¹ Dowling, N. A., Cowlishaw, S., Jackson, A. C., Merkouris, S. S., Francis, K. L., & Christensen, D. R. (2015). Prevalence of psychiatric co-morbidity in treatment-seeking problem gamblers: A systematic review and meta-analysis. *Australian & New Zealand Journal of Psychiatry*, 49(6), 519-539.



**Proudly
Australia's largest
private specialty
health care group**
and leading provider
of whole-of-life mental
health services.

Aurora

aurorahealth.com.au
f t i a [aurorahealthau](https://www.instagram.com/aurorahealthau)

People first.
People always.



**ODYSSEY HOUSE
VICTORIA**

Alcohol & other drug treatment, training and support.

Odyssey House recognises that alcohol and other drug problems can have a significant impact on children and other family members.

We also aim to support and make our services relevant to the widest range of people, welcoming all Aboriginal and Torres Strait Islander peoples, those from culturally diverse backgrounds, and those from lesbian, gay, bisexual, trans and gender diverse, intersex, and queer and questioning (LGBTQI+) communities to our services.

For more information visit www.odyssey.org.au or
contact our friendly staff:
(03) 9420 7600
odyssey@odyssey.org.au



Social Media

Follow Us

Australian and New Zealand Mental Health Association

Facebook

www.facebook.com/ANZMHA

@anzmha



LinkedIn

[www.linkedin.com/
company/4844914](https://www.linkedin.com/company/4844914)



Twitter

www.twitter.com/ANZMHA

#anzmha



Social Media Competition

Use hashtag #ADD22 or tag @ANZMHA
highlighting your favourite moments of our conference...

...and go into the draw to WIN one of these prizes:

- 1x FREE virtual registration to ADD23
- 1x FREE in-person registration to any of our ANZMHA conferences (you choose!)



Keynote Presenters



Tony Clarkson

Principal Clinical Advisor

Victorian Responsible Gambling Foundation

Gambling Addiction – The Poor Cousin of AOD and Mental Health

Tuesday 10 May | 2:45pm - 3:15pm

Tony trained as a psychodynamic psychotherapist for six years in London. He is the Vice-President of PACFA (Psychotherapy & Counselling Federation of Australia) and a board member with the South Eastern Melbourne Primary Health Network, where he also chairs the Clinical & Community Council.

Tony also co-chairs the National Mental Health Commission's Self Stigma Technical Advisory Group, which contributes to the development of a National Stigma & Discrimination Reduction Strategy.

He currently works as the Principal Clinical Advisor at the Victorian Responsible Gambling Foundation (Victorian Department of Justice & Community Safety), where he provides clinical advice for a state-wide gambling addiction service system.



Lotta Dann

Writer, Blogger, Story Teller,
Lived Experience
New Zealand

Lived Experience (How to Reduce Judgement and Stigma)

Monday 9 May | 9:20am – 9:50am

Lotta Dann has a Master's degree in communications and media studies. She worked for 25 years as a TV journalist and producer while also developing a nasty addiction to alcohol. She got sober in 2011 with the help of an anonymous blog called 'Mrs. D Is Going Without' which became a best-selling memoir of the same name. She has since published 'Mrs D Is Going Within' and 'The Wine O'Clock Myth: The Truth You Need to Know About Women and Alcohol'. She now manages the large online peer support community Living Sober funded by the New Zealand Drug Foundation and Health Promotion Agency, and works as a Lived Experience Facilitator of Addiction 101 workshops through Blueprint for Learning.



Dr Stephanie Merkouris

Lecturer

School of Psychology, Deakin University

Keynote Panel - What's Next? Bold Dreams & New Directions

Tuesday 10 May | 3:15pm – 4:30pm

Dr Stephanie Merkouris is a Lecturer in the School of Psychology at Deakin University and is currently the recipient of a New South Wales Office of Responsible Gambling Postdoctoral Fellowship. Dr Merkouris has been working as a researcher in the gambling field for 12 years. Her main research interests relate to the examination of factors associated with the development, maintenance and treatment of gambling-related problems, and the development and evaluation of evidence-based treatments for gambling. She is particularly interested in how advances in technology can be used for assessment, intervention, and dissemination purposes, with her recent research focusing on the application of e-mental health in the gambling field.



Jack Nagle

Real Drug Talk Founder

Keynote Panel - What's Next? Bold Dreams & New Directions

Tuesday 10 May | 3:15pm – 4:30pm

Jack is an everyday Australian passionate about finding and creating solutions for service consumers in the Alcohol and Other Drugs sector. His passion comes from his own experience of substance addiction and consuming services in some of his most vulnerable moments.

After sharing his story extensively in all forms of National media, Jack created Real Drug Talk. In his role as founder and director, he sits on a number of National government, non-government and research advisory committees, advocating for the importance of developing the lived and living experience workforce.



Simon Ruth
Chief Executive Officer
Thorne Harbour Health

Preventing and Treating Addictive Behaviours: The Role of Trauma

Monday 9 May | 8:50am – 9:20am

Simon Ruth is CEO at Thorne Harbour Health (THH), formerly the Victorian AIDS Council. Simon has spent most of his career working in, or managing, alcohol and drug programs. THH provides LGBTI specific AOD programs in Victoria and South Australia. Simon has previously worked in AOD services for the Salvation Army, YSAS, Monash Health and Peninsula Health. Simon was VAADA President from 2007-2012. He was previously awarded a Victorian Traveling Fellowship to investigate older adult AOD treatment in the USA and Canada. He currently sits on the Boards of the AIDS Trust of Australia and Pride Cup Australia.



John Ryan
Chief Executive Officer
Penington Institute

The Decriminalisation Debate: The Effectiveness of Decriminalisation in Addressing Problematic Drug Use

Monday 9 May | 11:40am – 12:10pm

John is a leader in public health whose expertise is widely recognised in Victoria and overseas. He is currently a member of the North Richmond Medically Supervised Injecting Room Review Panel and, in 2012, won a Churchill Fellowship to travel to the United States and study ways of improving public health approaches to drug policy. As a former Needle and Syringe Program worker, university researcher and policymaker, John is deeply committed to promoting better approaches to substance use and leading Penington Institute's work to create change for the better.



Robert Skeen
Chief Executive Officer
*Aboriginal Health and Medical
Research Council NSW*

Responding to the Needs of our Indigenous Peoples

Monday 9 May | 10:30am – 11:00am

Robert Skeen has traditional ties to the Gubbi Gubbi of the Sunshine Coast, Mununjari of Southeast QLD, and Waanyi of Northwest QLD. He has worked in the Government and Aboriginal Community Controlled Health Organisation Sector for almost 25 years. Prior to being the AH&MRC CEO, he was a member of the AH&MRC Human Research Ethics Committee and was also a member of the NSW Working Party for the NACCHO constitution reform. Robert has developed into a strong leader who has a proven track record of high-level leadership, change management, and innovation. His focus as a CEO now is to use his talents to rebuild organisations, and ensure organisations are viewed by all stakeholders as viable businesses that are healthy and smart.



Robert Stirling
Chief Executive Officer
*The Network of Alcohol and
other Drugs Agencies*

Challenges and Opportunities: A Skilled, Supported and Multidisciplinary AOD Workforce

Monday 9 May | 11:00am – 11:30am

Robert Stirling is CEO for the Network of Alcohol and other Drugs Agencies (NADA) and is responsible for representing the interests of the NSW non-government AOD sector across policy, sector and workforce development, and research. He sits on a number of national and NSW boards and committees representing the NGO AOD sector. Robert has worked in the AOD sector for 15 years across the government and NGO sectors and holds qualifications in public health and community management. He is currently undertaking a doctorate exploring performance measurement of AOD treatment.



**Associate Professor
Chris Wilkins**
*SHORE & Whariki Research Centre,
Massey University, New Zealand*

Preferences for Different Cannabis Law Reform Options Among the General Population and Key National Stakeholders in New Zealand

Monday 9 May | 12:10pm – 12:40pm

Keynote Panel - What's Next? Bold Dreams and New Directions

Tuesday 10 May | 3:15pm – 4:30pm

Associate Professor Chris Wilkins is the leader of the drug research team at SHORE & Whariki Research Centre, Massey University, New Zealand. Chris has research expertise in drug trends, drug markets, and drug policy. Over the past twenty years he has completed a range of studies of drug use in New Zealand with particular focus on cannabis, methamphetamine, NPS, ecstasy, and organised crime and the economics of illegal drug markets. He recently co-editing a book on cannabis legalisation (*Legalizing Cannabis: Experiences, Lessons and Scenarios*, with Tom De Corte, Simon Lenton). He leads the online New Zealand Drugs Trends Survey.

TURN TO HELP

An essential resource for
healthcare professionals who treat
patients with **opioid dependence**



Visit Turn to Help for information on opioid dependence,
its treatment options, and long-term management.
www.turntohelp.com.au



**Australian & New Zealand
Mental Health Association**

2022 PRESENTER OPPORTUNITIES

**Share your latest projects, developments, insights,
or experiences in mental health care**

International Mental Health Conference

Presenter submissions close 13 May. Visit anzmh.asn.au/imhc-2022

Discuss challenges and opportunities on best practice, grow meaningful connections and provide solutions to mental health care.

Indigenous Wellbeing Conference

Presenter submissions close 10 June. Visit anzmh.asn.au/iwc-2022

Share how to effectively empower Indigenous populations to harness and strengthen physical, spiritual, and cultural needs.

Australian Rural & Remote Mental Health Symposium

Presenter submissions close 15 July. Visit anzmh.asn.au/rrmh-2022

Provide practical advice and tools to advance mental health and improve services in Australia's rural and remote communities.

STOP Domestic Violence Conference

Presenter submissions close 22 July. Visit anzmh.asn.au/sdvc-2022

Discuss new tools, resources and practical strategies for domestic and family violence prevention, intervention, treatment and rehabilitation.

Program DAY 1

Monday 9 May | 7:45am - 5:00pm Exhibition Open

7:45am - 8:30am

Registration Open

Welcome! Come and say hello to the Conference Team and collect your Name Badge!

Keynote Session 1: Understanding Addiction

Chair: Dr. Stefan Gruenert

8:30am - 8:40am

Welcome to Country

8:40am - 8:50am

Welcome & Housekeeping

Talitha Natt, Business Partnerships Manager, Australian & New Zealand Mental Health Association

8:50am - 9:20am

Opening Address: Preventing and Treating Addictive Behaviours: The Role of Trauma

Simon Ruth, Chief Executive Officer, Thorne Harbour Health

9:20am - 9:50am

Lived Experience (How to Reduce Judgement and Stigma)

Lotta Dann, Writer, Blogger, Storyteller, Lived Experience (Live stream from New Zealand)

9:50am - 10:00am

Q&A

10:00am - 10:30am

Morning Tea with Exhibitors

Keynote Session 2: Challenges and Opportunities

Chair: Dr. Stefan Gruenert

10:30am - 11:00am

Responding to the Needs of our Indigenous Peoples

Robert Skeen, Chief Executive Officer, Aboriginal Health and Medical Research Council NSW

11:00am - 11:30am

Challenges and Opportunities: A Skilled, Supported and Multidisciplinary AOD Workforce

Robert Stirling, Chief Executive Officer, The Network of Alcohol and other Drugs Agencies

11:30am - 11:40am

Q&A

Keynote Session 3: Alcohol and Other Drugs - Cross Comparison of Services

(Co-Presentation of AU + NZ)

Chair: Dr. Yvonne Bonomo

11:40am - 12:10pm

The Decriminalisation Debate: The Effectiveness of Decriminalisation in Addressing Problematic Drug Use

John Ryan, CEO, Penington Institute

12:10pm - 12:40pm

Preferences for Different Cannabis Law Reform Options Among the General Population and Key National Stakeholders in New Zealand

Associate Professor Christopher Wilkins, Massey University, New Zealand

12:40pm - 12:50pm

Q&A

12:50pm - 1:30pm

Lunch with Exhibitors

Intervention, Withdrawal & Treatment

Chair: Dr. Steph Kershaw
BALLROOM 1 & VIRTUAL VIA ONAIR

Prevention, Promotion & Early Intervention

Chair: Dr Hester Wilson
BALLROOM 2 - IN PERSON ONLY

Study

Chair: Jennifer Connolly

TAMBORINE GALLERY - IN PERSON ONLY

1:30pm - 1:50pm

Medicinal Psychedelics for Treatment of Addiction

Assoc. Professor Yvonne Bonomo, Director, Dept Of Addiction Medicine, St Vincents Hospital, University of Melbourne

Painting the Picture: The Media's Role in Representing Substance Use

Peta Dampney, Principal Trainer and Consultant, From Me to You Consulting

Logan Community Outreach: Needs Analysis for Children and Young People at Risk or Engaged in Volatile Substance Misuse
Marilyn Casley, Lecturer, School of Health Sciences & Social Work, Griffith University (Logan Campus)

1:55pm - 2:15pm

The Addiction to Criminalisation Epidemic

Bianca Amoranto, Senior AOD Transition Worker, Community Restorative Centre and Stefanie Wong, AOD Transition Worker, Community Restorative Centre

Addiction and Narcissistic Families

Janine Elliott, Manager, Gold Coast Detox and Rehab Services

Implementation Quality Efficacy: NSP Providers and People Who Inject Drugs
Danielle Resiak PhD, University of Sydney

2:20pm - 2:40pm

Crossroads in Recovery - Dreams and Directions

Dr Ashwini Padhi, Psychiatrist and Di Young, Addiction and Trauma Specialist, South Pacific Private

Benchmarking the Protective and Risk Factors for Workaholism in Professionals

Audrey McGibbon, Director / Psychologist, EEK & SENSE / GLWS

An Efficient New Protocol for Transition of Patients on Methadone Treatment to Long-acting Injectable Buprenorphine (LAIB)

Dr David Jacka, Addiction Medicine Specialist, Mental Health, Monash Health

2:40pm - 3:10pm

Afternoon Tea with Exhibitors

Aftercare Peer Support 1
Chair: Gary Fahey

BALLROOM 1 & VIRTUAL VIA ONAIR

Indigenous Focused Intervention
Chair: Dr Michael Doyle

BALLROOM 2 - IN PERSON ONLY

Panel Presentation
Chair: Dr Yvonne Bonomo

TAMBORINE GALLERY -
IN PERSON ONLY

3:10pm - 3:40pm

Developing an AOD Peer Workforce in Tasmania

Majella Eales, AOD Specialist, The Salvation Army Bridge Program and Jeffrey Ryan, Peer Support Worker, The Salvation Army, Alcohol and other Drugs

Removing Barriers to Equitable Healthcare through Culturally Safe Resource Support

Joanne Hoareau, Senior Research Coordinator, Australian Indigenous Healthinfonet

Family Violence Informed AOD Practice – The Journey So Far

Anne Tidyman, Manager Child And Family Services, Odyssey House Victoria, Taran Dhillon, Programs Coordinator, Odyssey House Victoria and Sona Bajaj, Clinical Coordinator, Odyssey House Victoria

3:45pm - 4:15pm

Care Navigation: An Inclusive Pre and Post-care Holistic Collaboration Model

Dominique Robert-Hendren, Head Of Clinical Innovation And Digital Health, Hello Sunday Morning | Live Stream Virtual Presenter

The ADARRN Model of Care in a Residential Rehab Setting

Chris Mason, Counsellor, The Glen / ADARRN

Panel Continued

4:20pm - 4:50pm

Substance Dependency as an Attachment Disorder: Implications for Long-Term Recovery

Nadine Missenden, Therapies Manager, The Banyans Health and Wellness | Live Stream Virtual Presenter

The Role of Relationship: Learnings from the World's Oldest Continuing Culture

Mark Hammersley, Manager, Dardi Munwurro

Panel Continued

4:50pm - 5:00pm

Poster Presentations
IN PERSON ONLY

Alcoholism: A Family Disease

Helen Gillies, CEO, Al-Anon Family Groups Australia

Consumer Engagement through Peer Work

Peter Baird, Peer Support Worker, Each

Development of a Culturally Appropriate, National Website about Crystal Methamphetamine

Dr Steph Kershaw, Research Fellow, The Matilda Centre for Research in Mental Health and Substance Use

Dreaming UP or Dreaming OF-Re-engaging the Keys for Sound Personhood

Shane Varcoe, Executive Director, Dalgarno Institute

Have You Tried This? A Visual Substance Use Assessment Tool

Laura Quinlan, Dual Diagnosis Coordinator, Child and Youth Mental Health Service (CYHMS)

Measuring Treatment Success in the Move towards Value-Based Funding

James Curtain, Clinical Director, Lives Lived Well

Holly Stokes, Research and Outcomes Coordinator, Lives Lived Well

Mingu Yabun – Spiritually Speaking and Sharing

Russell Bickford, Senior Coordinator Community Programs, Odyssey House NSW
Sally Bruce, Coordinator Community Programs, Odyssey House NSW

Support the Family - Improve the Outcome

Chrissie Kelly, Qld State Manager, Family Drug Support

Utilising Low Intensity Mental Health Services in Hard Times

Marc Di Cioccio, Team Leader (NewAccess), Lives Lived Well

The Journey of Medicinal Cannabis in Australia

Dr Yvonne Bonomo, Director, Department of Addiction Medicine, St Vincent's Hospital, Melbourne

5:00pm - 6:00pm

Networking Function

Tamborine Gallery

Program DAY 2

Tuesday 10 May | 8:30am - 3:00pm Exhibition Open

8:30am - 9:00am

Registration Open

Intervention, Withdrawal & Treatment 2

Chair: Dr Michael Doyle

BALLROOM 1 & VIRTUAL VIA ONAIR

Models of Care

Chair: Dr Hester Wilson

BALLROOM 2 - IN PERSON ONLY

CALD & Marginalised Communities

Chair: Gary Fahey

TAMBORINE GALLERY - IN PERSON ONLY

9:00am - 9:30am

Breaking the Residential Myth: effective triaging in AOD Services

Richard Salewicz, Clinical Services Manager and Karla Milner, Clinical Psychologist, Clinical Services Manager - Tasmania, Bridge Treatment and Recovery Services, The Salvation Army, AOD Services Tasmania

Treatment and Recovery: Bringing Focus to the Role of Relationship

Greg Smith, PhD Candidate/ AOD Therapist, University of Melbourne

Unpacking Layers of Migrants & Refugees Cultural Experiences AOD Recovery

Petronilla Mazai, Director, Grace Homestead

9:35am - 10:05am

Pivoting to Online and Hybrid Service Delivery

Russell Bickford, Senior Coordinator and Sally Bruce, Coordinator, Odyssey House NSW

Implementing a National Model of Care for Service Excellence

Kathryn Wright, General Manager, AOD Services, The Salvation Army, Penny Chugg, State Manager, Tasmania, The Salvation Army AOD and Andy Biddle, State Manager NSW/ ACT, The Salvation Army

Insights from the Establishment of Three Low-Medical Withdrawal Units

David Lonnie, General Manager, Residential Services, Cyrenian House

10:10am - 10:40am

One Step Forward, Two Steps Back

Cornelius "Kees" Nydam, Clinical Director Addiction Medicine Service, Wide Bay Hospital and Health Service

When Words Fail, Music Speaks. AOD, Child Protection and Music

Michael Cameron, Youth Principal AOD Practitioner And Senior Trainer And Practice Consultant, YSAS

Finding Digital Mental Health Resources for Addiction

Dr Jennifer Connolly, Senior Research Fellow, Qld University of Technology

10:40am - 11:00am

Morning Tea with Exhibitors

Impacts within Legal & Prison System

Chair: Holly Stokes

BALLROOM 1 & VIRTUAL VIA ONAIR

Digital Solutions

Chair: Jennifer Connolly

BALLROOM 2 - IN PERSON ONLY

Prevention, Promotion & Early Intervention #2

Chair: Carol Daws

TAMBORINE GALLERY - IN PERSON ONLY

11:00am - 11:20am

Women in Recovery: Outcomes from a Prison-based Therapeutic Community

Cynthia Murray, Program Design Lead, Caraniche

Telehealth Home Alcohol Detox - Making Services More Accessible and Convenient

Dr Annie Banbury, Clinical Lead, Covi and Dr Chris Davis, Chief Medical Officer, Clean Slate Clinic

Alcohol and Pregnancy: Interventions for Fetal Alcohol Spectrum Disorder (FASD)

Sophie Harrington, Chief Operating Officer, Nofasd Australia

11:25am - 11:45am

Wandoo Women's Rehabilitation Prison Therapeutic Community: The First Three Years

Tom Hopkins, General Manager Justice Services, Cyrenian House

Effectiveness of Telehealth App for the Treatment of Substance Abuse

Melinda Symon, Director, Hader Clinic Queensland

Promotion of Healthy Gaming Screen Use in Education Settings

Wendy Mills, Ed-ling Coordinator, Chq Cymhs

11:50am - 12:10pm

Screening for AOD Use - Problems of Aboriginal People Entering Prison

Dr Michael Doyle, Senior Research Fellow, The Centre of Research Excellence in Indigenous Health and Alcohol, Sydney University

Tuesdays with Nexus, an interactive online service collaboration

Ange Wallace, Senior Dual Diagnosis Clinician, Nexus and Sarah Officer, NEMHSCA Co-ordinator, Banyule Community Health

Achieving Positive Outcomes in Residential Programs: Partnering Practice and Research

Mikel Gellatly, Clinical Services Manager (central Queensland Residential), Lives Lived Well

12:15pm - 12:35pm	Successful Transition from Prison to Family, Employment & Education David Gunter, General Manager NRP, Fresh Start Recovery Programme	Evaluating a Digital Health Initiative about Crystal Methamphetamine ('ice') Dr Steph Kershaw, The Matilda Centre for Research in Mental Health and Substance Use	Labels are for Jam Jars: Changing Narratives and Destigmatising Addiction Daniel Raffell, National Program Manager, Smart Recovery Australia
12:35pm - 1:15pm	Lunch with Exhibitors		
	Aftercare Peer Support 2 Chair: Tony Clarkson BALLROOM 1 & VIRTUAL VIA ONAIR	Intervention, Withdrawal & Treatment 3 Chair: James Curtain BALLROOM 2 - IN PERSON ONLY	AOD Intervention & Treatment Chair: Carol Daws TAMBORINE GALLERY - IN PERSON ONLY
1:15pm - 1:35pm	Identity Reassignment - A Forward Focused Approach to Sustained Recovery Gary Fahey, Founder, Strong Men'd	SMART Track: Feasibility of Smart Phone App for SMART Recovery Professor Peter Kelly, University of Wollongong	AOD Assertive Outreach Multi-D Pilot Engaging Treatment Resistance Clients Michelle Edmondson, AOD Program Manager and Jordan Crouch, Team Leader within Next Steps program, AOD clinician, Life Without Barriers
1:40pm - 2:00pm	Innovative Nutraceuticals Compounds Useful in Treatment of Addiction and Recovery Mary-Louise Condon, Senior Compounding Pharmacist, The Compounding Lab	Holistic, Client-Centred Care in the AOD Sector, a Rural Perspective Lisa Courtney, Clinical Services Manager, Murray Mallee GP Network	Dardi Munwurro Men's Healing and Behaviour Change Program Mike Richardson, Drug & Alcohol Clinician, Dardi Munwurro
2:05pm - 2:25pm	Real World Insights: Brief Counselling Interventions for Generalist Clinicians and Health Workers Dr Mary Emeleus, Psychiatry Registrar at Currumbin Clinic, General Practitioner and Psychotherapist	The NSW BTRC: A Brain Bank for Alcohol Research Associate Professor Greg Sutherland, The University of Sydney	AOD Concerns Within a Child and Youth Mental Health Setting Laura Quinlan, Dual Diagnosis Coordinator, Child And Youth Mental Health Service (cyhms)
2:25pm - 2:45pm	Afternoon Tea with Exhibitors		
	Keynote Session 4: Gambling Addiction Chair: Dr Eli Kotler BALLROOM 1 & VIRTUAL VIA ONAIR		
2:45pm - 3:15pm	Gambling Addiction – The Poor Cousin of AOD and Mental Health Tony Clarkson, Principal Clinical Advisor, Victorian Responsible Gambling Foundation		
3:15pm - 4:30pm	Keynote Panel: What's Next? Bold Dreams & New Directions <ul style="list-style-type: none"> - Behavioural issues, Gambling, Tech, Gaming, Hoarding, Sex, Porn etc. - Dark web, novel substances - Compounding issues, comorbidity - COVID learnings: how much do we keep for future reference? Panel Chair: Dr Eli Kotler, Medical Director, Malvern Private Hospital Panelist: Jack Nagle, Real Drug Talk Founder Panelist: Associate Professor Christopher Wilkins, Massey University, New Zealand Panelist: Dr Stephanie Merkouris, Lecturer, School of Psychology, Deakin University		
4:30pm - 4:40pm	Conference Close & Prize Draw		



SOUTH PACIFIC PRIVATE

Australia's Leading Treatment Centre

Changing lives, Healing Families

Since 1993, Australia's leading treatment centre, South Pacific Private specialises in trauma-informed treatment for addiction, complex trauma and co-occurring mood disorders.

Call us to refer a client, or for more information.

Enquire today 1800 063 332

southpacificprivate.com.au

- + Fully accredited psychiatric treatment centre
- + Psychotherapy driven
- + Abstinence based
- + Trauma-informed framework
- + Family system perspective
- + Therapeutic community support
- + Intensive inpatient treatment and out patient treatment options available

Program DAY 3

Wednesday 11 May

8:30am - 9:00am

Registration Open

Workshop 1
IN PERSON ONLY

Workshop 2
IN PERSON ONLY

Workshop 3
IN PERSON ONLY

9:00am - 10:30am

Therapeutic Potential of Ketamine and other Psychedelic Medicines in Addictions
Nikola Ognyenovits, Consultant, Qld Health, Private Practice

Collaborative Clinical-Coach Therapy for a Parent Who Used Substances
Don Tustin, Clinical Director, Adelaide Psychological Services

Migrants, Refugees, Culture and Religion - Considered Support for Diverse Clients
Nasreen Hanifi, Clinical Director, Hayat House, Addiction Services for CALD communities, Mission of Hope, Teguh Syahbahar, AOD Clinician, Mission of Hope and Zainab Hassib, AOD Clinician, Mission of Hope

10:30am - 11:00am

Morning Tea

Workshop 4
IN PERSON ONLY

Workshop 5
IN PERSON ONLY

Workshop 6
IN PERSON ONLY

11:00am - 12:30pm

Meth City: Addiction Recovery for Prisoners
Tabitha Corser, Program Director, The Whitehaven Clinic

Focusing on the Why in Substance Use and Abuse
Peta Dampney, Principal Trainer And Consultant, From Me To You Consulting

Effectively Recognise, Screen and Provide Brief Intervention for Problem Gambling
Richard Wilson, Gambling Intervention Counsellor & Gambling Screening Training Coordinator, Lives Lived Well

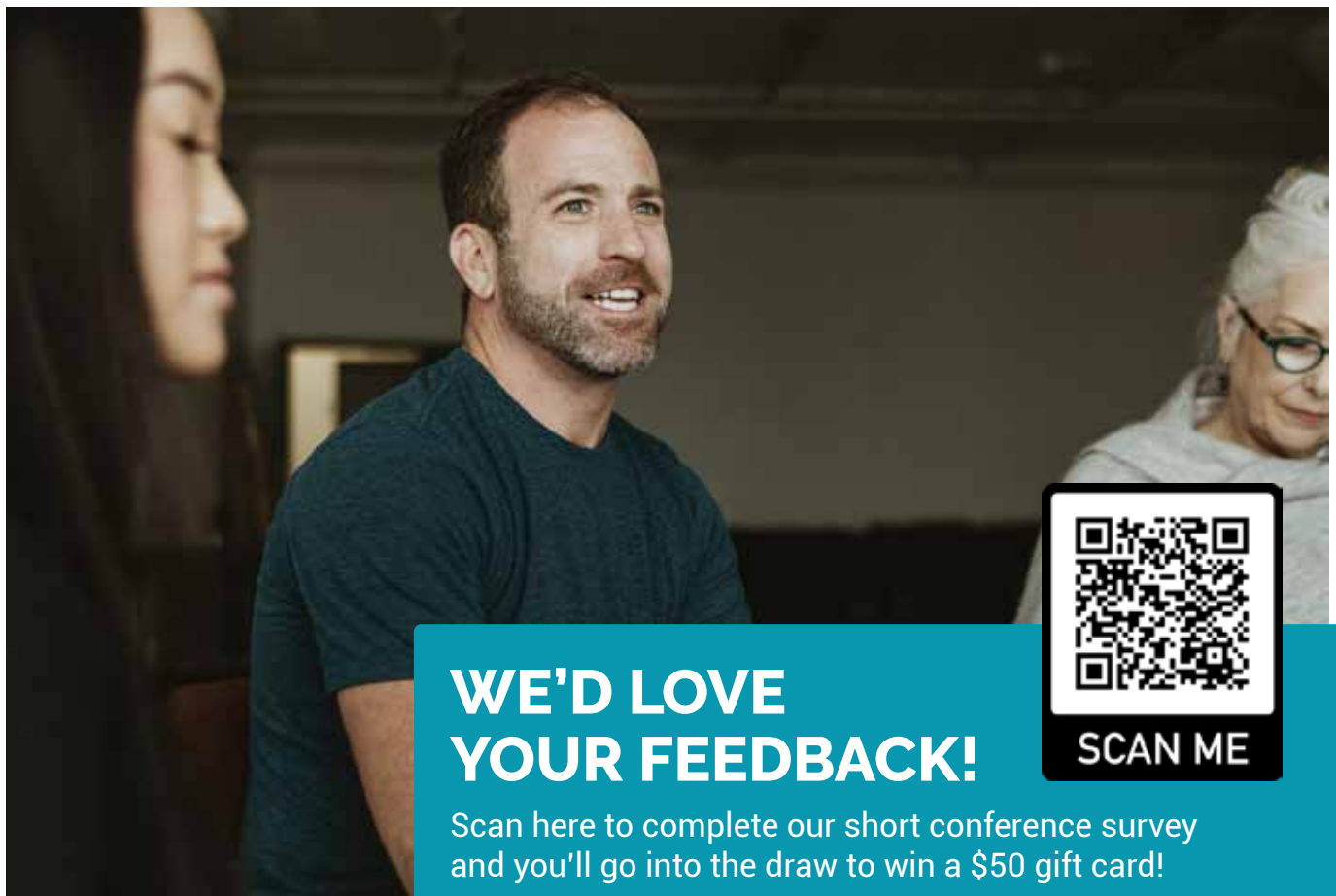

WE'D LOVE YOUR FEEDBACK!

Scan here to complete our short conference survey and you'll go into the draw to win a \$50 gift card!



HOST CITY PARTNER

DESTINATION
GOLDCOAST.



PRINCIPAL SPONSOR

The Queensland Mental Health Commission (the Commission) drives the reform of the mental health and alcohol and other drugs systems in Queensland. The Commission encourages and facilitates change to improve the mental health and wellbeing of all Queenslanders, with a focus on:

- improving the mental health and wellbeing of all Queenslanders
- preventing and reducing the impact of mental illness
- preventing and reducing the impact of problematic alcohol and other drug use
- preventing and reducing the impact of suicide.

The Commission actively seeks the views and experiences of people with a lived experience to help shape the reform agenda. The collective effort of all stakeholders is essential to bring about reform and better outcomes for all Queenslanders. The Commission works across a broad range of areas including health, social, education, child safety, employment, economic and justice sectors. The Commission is a statutory body established under the Queensland Mental Health Commission Act 2013.

Phone: 1300 855 945
Website: qmhc.qld.gov.au



GOLD SPONSOR

Indivior is the world leader in addiction treatment with over 20 years' experience and a unique patient focused approach. Our endeavour is to understand the journey of individuals suffering with addiction. We partner with healthcare professionals, the public health community, policymakers, and payers to ensure people suffering from addiction are treated just like any other patients suffering from a chronic, relapsing medical condition. At Indivior our endeavour is to focus on individual patients around the world. The patient continues to drive our decisions. Our guiding principles foster a corporate culture of trust, innovation, and a pioneering spirit. We work with the urgency and zeal required to achieve required to achieve our vision of ensuring unrestricted access to high-quality treatments for the chronic relapsing conditions and co-morbidities of addiction.

Email: louise.hume@indivior.com
Website: indivior.com/en



PLATINUM SPONSOR

The Victorian Responsible Gambling Foundation is a statutory authority working to prevent, reduce and treat gambling harm in Victoria. We work with partners, communities and the government to deliver effective, evidence-based initiatives and innovative approaches to prevent gambling harm and provide support for those seeking help.

Phone: 03 9452 2600
Email: contact@responsiblegambling.vic.gov.au
Website: responsiblegambling.vic.gov.au

SOUTH PACIFIC PRIVATE

Australia's Leading Treatment Centre

GOLD SPONSOR

For 30 years South Pacific has been Australia's leading treatment centre for addiction, trauma, mood disorders, anxiety and dual diagnosis. Our mission is 'to change lives and heal families' by providing all Australians with the most comprehensive and evidence-based recovery programs.

Phone: 02 9905 3667
Email: support@southpacificprivate.com.au
Website: southpacificprivate.com.au



SILVER SPONSOR

As a new biopharmaceutical company, AbbVie combines the expertise of a recognised pharmaceutical company with the focus and innovative spirit of a biotech. Through a targeted, patient-centric approach to research and development, AbbVie accelerates new scientific discoveries to address some of the most complex diseases in the world, while our services and partnerships help us create greater access and outcomes for the health of all Australians. We focus on discovering, developing, and delivering medicines in therapeutic areas where we have proven expertise and where we can have an impact. These areas include: Immunology, Oncology, Virology and Neuroscience.

Phone: 0401 200 674
Website: abbvie.com.au



SILVER SPONSOR

Camurus is a Swedish research-based pharmaceutical company committed to developing innovative and differentiated medicines for the treatment of severe and chronic conditions. New drug products are conceived based on the proprietary lipid-based FluidCrystal® drug delivery technologies and an extensive research and development expertise. Camurus Australia's focus is on opioid dependence, with the aim of simplifying treatment and removing the burden and stigma for patients and their families. If you wish to learn more about Camurus' medications, please visit the Buvidal website.

Phone: 1800 142 038
Email: australia@camurus.com
Website: buvidal.com.au



BRONZE SPONSOR

Aurora Healthcare is Australia's largest private specialty healthcare group focused on mental health, rehabilitation, specialty medical and community services. Our Australian portfolio comprises 16 private hospitals and community services in Australia's major cities and key regional areas. We are the nation's leading provider of mental health services, with 1,000 beds across Queensland, New South Wales, Victoria and Western Australia – and soon in the ACT.

Aurora Healthcare proudly provides mental health treatment and services across the age spectrum, including adolescents, adult and older persons. Collectively, we target a broad range of specific diagnostic areas, making us the expert and leader in mental health; our expertise across sub-specialties includes depression, anxiety, addictions, trauma, PTSD, perinatal and eating disorders.

We are now recruiting for suitably qualified psychiatrists, registrars and nurses to join our dynamic hospital teams.

Phone: 02 9531 0300
Email: marketing@aurorahealth.com.au
Website: aurorahealth.com.au



BRONZE SPONSOR

Odyssey House Victoria (OHV) is a specialist drug and alcohol treatment, training and support organisation that assists more than 16,000 people each year on their journey to recovery. OHV provides a range of community treatment programs across Victoria and supports around 200 residential treatment beds across four locations using the Therapeutic Community model. OHV provides opportunities for change and growth by reducing drug use, improving mental health, and reconnecting people to families and the community. We work collaboratively with other services and sectors to provide holistic, recovery-focused interventions that are tailored to clients' individual differences and diverse needs. OHV also provides a range of education, prevention and support programs to families and community groups. As one of the first services to incorporate child and family approaches, mental health, family violence, vocational training, and employment programs into its AOD treatment program, OHV is actively involved in developing innovative and holistic approaches to treatment, and is committed to contributing to the evidence base through a number of research projects.

Phone: 03 9420 7600
Email: odyssey@odyssey.org.au
Website: odyssey.org.au

Conference Exhibitors



Cracks in the Ice is an online toolkit providing trusted, evidence-based, and up-to-date information and resources about crystal methamphetamine ('ice') for the Australian community. Cracks in the Ice is supported by funding from the Australian Government Department of Health and was developed by the Matilda Centre for Research in Mental Health and Substance Use at the University of Sydney. The toolkit was developed in response to the Final Report of the National Ice Taskforce which was established in 2015 by the Australian Government to provide advice on the impacts of ice in Australia.

Phone: 02 8627 9626
Email: info@cracksintheice.org.au
Website: cracksintheice.org.au



Dardi Munwurro (Dardi) was established in 2000 to assist Aboriginal men and youth in identifying their emotions and personal strengths, and in doing so, discover their own responsibility to change behaviour. The organisation delivers a range of family violence, healing and behaviour change programs and services designed to break the cycle of inter-generational trauma in Aboriginal families and communities by empowering and inspiring individuals to heal the past, acknowledge the present and create a positive vision for the future. All of Dardi's programs are designed to support Aboriginal men and youth to express purpose and develop a vision for their future. The organisation is staffed by people strongly connected to the Aboriginal community, as well as supported by Community Elders.

Phone: 03 8456 3044
Email: info@dardimunwurro.com.au
Website: www.dardimunwurro.com.au



The e-Mental Health in Practice (eMHPrac) project is funded by the Commonwealth Department of Health and aims to raise awareness and knowledge of evidence-based digital mental health resources. eMHPrac delivers free presentations, workshops and webinars to health practitioners throughout Australia. eMHPrac is led by Queensland University of Technology and partners with Black Dog Institute, Menzies School of Health Research, and University Centre for Rural Health (University of Sydney).

Phone: 02 6620 7570
Email: heidi.sturk@qut.edu.au
Website: emhprac.org.au



The Australian Indigenous Knowledge Centre's website contributes to improving the health of Australia's Aboriginal and Torres Strait Islander peoples and assist in closing the gap by providing the evidence base to help reduce the harmful use of alcohol and other drugs.

Phone: 08 9370 6336
Email: aodknowledgecentre@healthinfonet.org.au
Website: aodknowledgecentre.ecu.edu.au

Conference Exhibitors



Lives Lived Well works with people impacted by alcohol, drugs, gambling and mental health concerns. We offer free withdrawal, counselling and group programs. Our rehabilitation recovery centres, such as Mirikai, provide more comprehensive recovery support. We run the Lives Lived Well Specialist Centre, which is open to the public, and we are the lead agency for headspace Southport and headspace Upper Coomera.

Phone: 1300 727 957
Email: info@liveslivedwell.org.au
Website: liveslivedwell.org.au



PDP PESI leads the Australia / Asia-Pacific region with quality professional development training programs in behavioural and mental health.

Presented by world-leading clinical experts, available when, where, and how you want - discover today's most effective interventions and insights to help your clients thrive.

Choose from hundreds of programs:

Face-to-face events

- Live interactive webcasts and webinars
- Digital seminars and online courses
- In-house training at your venue wherever you are or via live virtual classrooms
- Resources in stock and ready to ship - workbooks, manuals, card-decks and flipcharts

With our satisfaction guarantee, it's risk-free quality with no fees on cancellations or transfers.

Contact us for a friendly chat about your training needs today!

Phone: 1300 887 622
Email: info@pdpseminars.com.au
Website: pdpseminars.com.au



The Banyans Healthcare Group is redefining the delivery of private health treatment for substance dependency in Australia. The Banyans offers a range of comprehensive, multidisciplinary residential, inpatient, and Telehealth treatment options. It has recently expanded its treatment offering with the addition of substance dependency and mental health day programs and a medical centre with primary and specialist care.

Phone: 1300 226 926
Email: wellness@thebanyans.com.au
Website: thebanyans.com.au



The Buttery is a not-for-profit charitable addiction and mental health organisation located in Northern NSW. Established in 1973, we have nearly 50 years' experience in supporting people to achieve recovery and rebuild their lives.

We deliver evidence-based long and short-term residential rehabilitation and outreach programs. The organisation also provides a unique counselling support program for families and carers. The Buttery has three residential programs including its social enterprise, The Buttery Private, plus the Therapeutic Community (TC) and Maintenance to Abstinence (MTA).

The Buttery has provided services to over 5,000 participants in its residential programs and 20,000 participants in its outreach services.

Phone: 02 6687 1111
Email: intake@buttery.org.au
Website: buttery.org.au

Help them turn their backs on opioid dependence

Buvidal® offers flexible dosing options to suit individual treatment needs.^{1,2}

Weekly/Monthly
Buvidal®
BUPRENORPHINE
MODIFIED RELEASE SOLUTION FOR
INJECTION FOR SUBCUTANEOUS USE

For resources and information visit www.buvidal.com.au

BEFORE PRESCRIBING, PLEASE REVIEW PRODUCT INFORMATION
AVAILABLE VIA THE QR CODES OR BY CALLING 1800 142 038.

BUVIDAL®
WEEKLY



BUVIDAL®
MONTHLY



PBS Information:

Buvidal® Weekly (8 mg, 16 mg, 24 mg and 32 mg) and Buvidal® Monthly (64 mg, 96 mg and 128 mg) are listed on the PBS as a Section 100 Opiate Dependence Items. Refer to PBS Schedule for full authority information. Buvidal® Monthly 160 mg is not listed on the PBS.

Please note that Buvidal® prescribing must comply with State and Federal regulations for opioids.

BOXED WARNINGS

RISK OF SERIOUS HARM OR DEATH WITH INTRAVENOUS INJECTION: Serious harm or death could result if administered intravenously. Buvidal® forms a gel depot upon contact with body fluids and may cause occlusion, local tissue damage and thrombo-embolic events, including life threatening pulmonary emboli, if administered intravenously. Additional warnings are associated with **HAZARDOUS AND HARMFUL USE, LIFE THREATENING RESPIRATORY DEPRESSION, CONCOMITANT USE OF BENZODIAZEPINES AND OTHER CENTRAL NERVOUS SYSTEM (CNS) DEPRESSANTS, INCLUDING ALCOHOL.**

Please refer to the Buvidal® Weekly and Buvidal® Monthly Product Information for the full boxed warnings.

References: 1. Buvidal® Weekly Australian Approved Product Information April 2021. 2. Buvidal® Monthly Australian Approved Product Information April 2021.

camurus

Buvidal® is the registered trademark of Camurus Pty Ltd. Camurus Pty Ltd, ABN 79 627 784 605. 223 Liverpool Street, Darlinghurst NSW 2010. Ph: 1800 142 038. AU-BUV-2200013. CAM-BUV-070. Date of preparation: March 2022.

We are AbbVie

We are a company that takes on some of the toughest health challenges. And we do more than just treat diseases – we aim to make a remarkable impact on people's lives.



abbvie

©2022 AbbVie Pty Ltd. ABN 48 156 384 262. All rights reserved. AbbVie® is a registered trademark of AbbVie Inc. 241 O'Riordan Street, Mascot NSW 2020. AU-ABBV-220085, April 2022

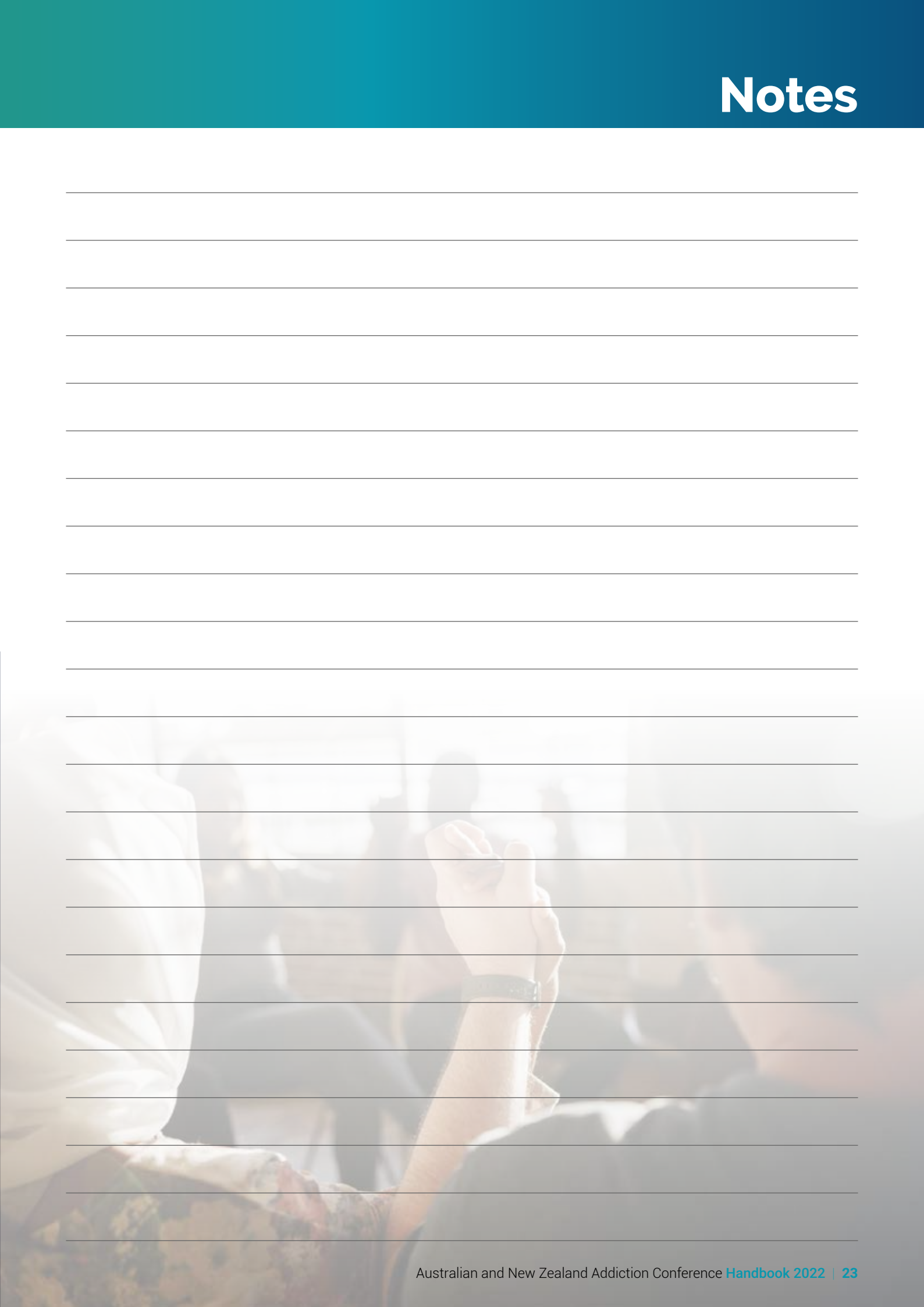

Notes

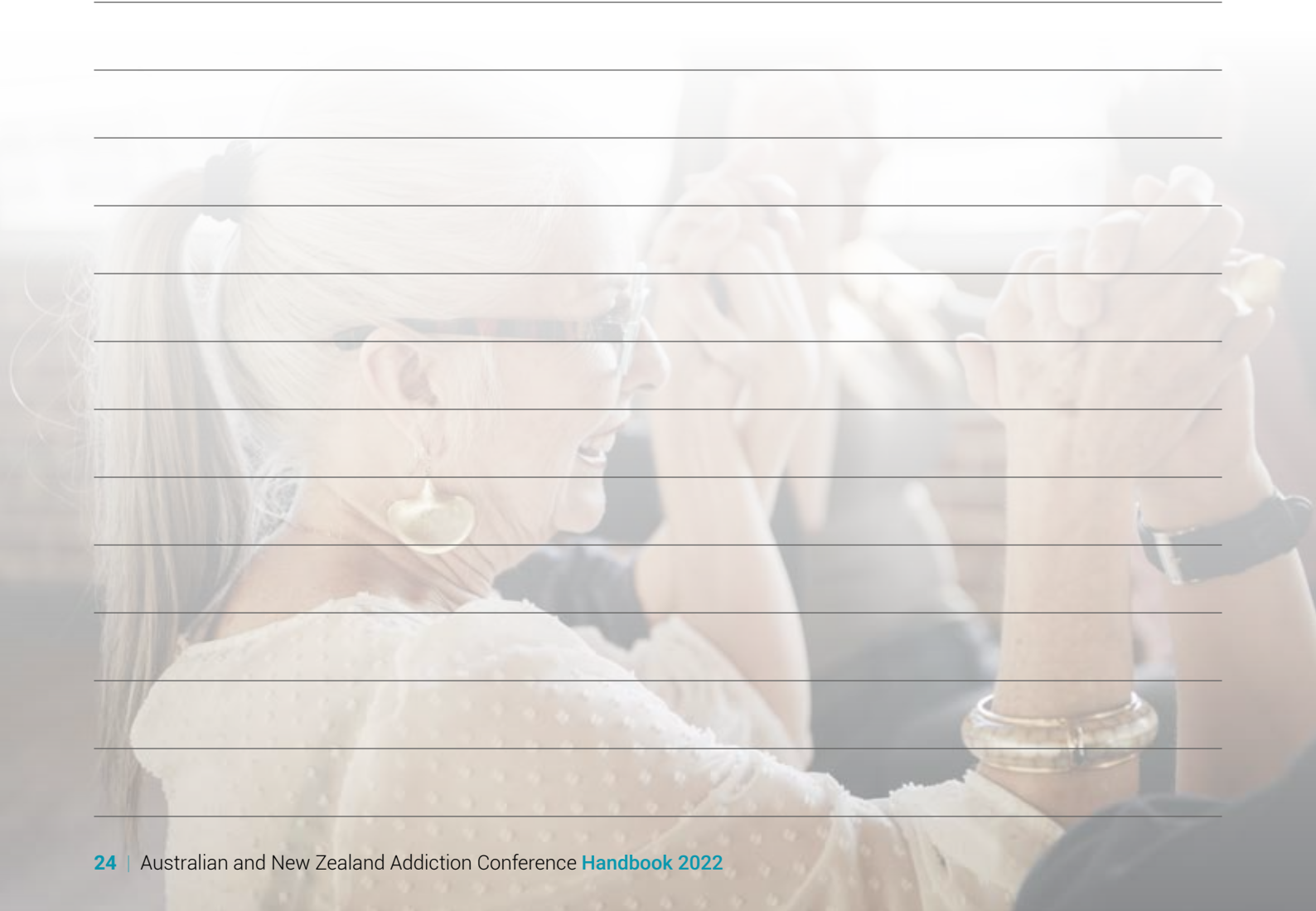

A smiling man with a beard and short hair, wearing a dark blue t-shirt, looking slightly to the left. The image is faded and serves as a background for a lined paper template.



**Australian & New Zealand
Mental Health Association**

2022 Events

Workplace Mental Health Symposium

22-24 August

Sea World Resort Conference Centre, Gold Coast QLD

Visit anzmh.asn.au/wmhs-2022

International Mental Health Conference

5 - 7 September

Gold Coast Convention Centre QLD

Visit anzmh.asn.au/imhc-2022

Indigenous Wellbeing Conference

24-25 October

Adelaide Oval, SA

Visit anzmh.asn.au/iwc-2022

Australian Rural & Remote Mental Health Symposium

9-11 November

Adelaide Oval, SA

Visit anzmh.asn.au/rrmh-2022

STOP Domestic Violence Conference

30 November - 2 December

RACV Royal Pines Resort Gold Coast

Visit anzmh.asn.au/sdvc-2022



**Australian & New Zealand
Mental Health Association**

**Join a
Community of
Mental Health
Advocates**

**Become a
Member**

Sign up for free at
anzmh.asn.au



Australian & New Zealand **ADDICTION CONFERENCE**

THANK YOU TO OUR SPONSORS AND EXHIBITORS

HOST CITY PARTNER

DESTINATION
GOLDCOAST.

SPONSORS



Queensland
Mental Health
Commission



Victorian
Responsible
Gambling
Foundation



SOUTH PACIFIC PRIVATE
Australia's Leading Treatment Centre

abbvie

camurus

Aurora



EXHIBITORS



eMHprac
E-MENTAL HEALTH IN PRACTICE



Lives Lived Well



Hosted by



Australian & New Zealand
Mental Health Association

anzmh.asn.au/addiction-conference | #ADD22